

DEPARTMENT OF THE ARMY TECHNICAL MANUAL

FIELD AND DEPOT MAINTENANCE MANUAL
PUMP, CENTRIFUGAL
FRESH WATER; GASOLINE
DRIVEN 2 WHEEL MOUNTED
4 IN 500 GPM, 30 FT HEAD
(CARVER MODEL K400S)
FSN 4320-810-7311 (LESS ENGINE)



SAFETY PRECAUTIONS

Before Operation

When the unit is operated in an inclosed area, exhaust gases must be piped to the out- side. Continued breathing of exhaust gases is dangerous and may be fatal.

Do not smoke or use an open flame when servicing the batteries. Batteries generate hydrogen, a highly explosive gas.

Exercise extreme caution when using a bromochloromethane fire extinguisher in an in- closed area. A deadly gas is generated by the contact of bromochloromethane with a heated metallic surface. Provide adequate ventilation before entering an inclosed area where bromochloromethane has been used.

During Operation

When the unit is operated in an inclosed area, exhaust gases must be piped to the out- side. Continued breathing of exhaust fumes is dangerous and may be fatal.

Use extreme caution when using a bromochloromethane fire extinguisher in an inclosed area. A deadly gas is generated by the contact of bromochloromethane and a heated metallic surface. Provide adequate ventilation before entering an inclosed area where bromochloromethane has been used.

After Operation

Do not smoke or use an open flame when servicing the batteries. Batteries generate hydrogen, a highly explosive gas.

Exercise extreme caution when using a bromochloromethane fire extinguisher in an inclosed area. A deadly gas is generated by the contact of bromochloromethane with a heated metallic surface. Provide adequate ventilation before entering an inclosed area where bromochloromethane has been used.

When making repairs on the fuel tank, make sure the tank is completely filled with clean water to eliminate all fumes which may cause an explosion.

FIELD AND DEPOT MAINTENANCE MANUAL

PUMP, CENTRIFUGAL: FRESH WATER; GASOLINE DRIVEN; 2 WHEEL MOUNTED; 4 IN., 500 GPM, 30 FT. HEAD (CARVER MODEL K400S) FSN 4320-810-7311 (LESS ENGINE)

		Paragraphs	Page
CHAPTER 1.	INTRODUCTION		
Section I.	General		
	Scope		
	Record and report forms	2	2
Section II.	Description and data		
	Description.....	3	2
	Tabulated data	4	2
CHAPTER 2.	GENERAL MAINTENANCE INSTRUCTIONS AND TROUBLESHOOTING		
	General	5	5
	Engine and pump.....	6	5
	Battery-charging generator fails to charge.....	7	5
CHAPTER 3.	BATTERY-CHARGING GENERATOR REPAIR INSTRUCTIONS		
	General.....	8	6
	Battery-charging generator.....	9	6
Section 4.	FUEL TANK, AXLE, AND CART BASE REPAIR INSTRUCTIONS		
	General	10	8
	Fuel tank.....	11	8
	Axle	12	8-9
	Cart base	13	9
APPENDIX	REFERENCES		
INDEX			

Chapter 1

INTRODUCTION

Section I. GENERAL

1. Scope

a. These instructions cover the Carver Pump Company, Model K400S Centrifugal Pump, less engine. They provide information on the maintenance of the equipment which is beyond the scope of the tools, equipment, personnel, or supplies normally available to using organizations. Refer to TM 5-2805-209-12 and TM 5-2805-209-35 for information and instructions on the engine.

b. The appendix contains a list of all publications referenced in the text. Appendix II of TM 5-4320-215-12 contains the Maintenance Allocation Chart. The list of repair parts required by field and depot maintenance facilities for support of this equipment is contained in TM

5-4320-215-35P.

c. Report all deficiencies as specified in AR 700-38. Submit recommendations for changes, additions, or deletions to The Commanding General, U. S. Army Engineer Maintenance Center, Corps of Engineers, ATTN: EMCDM. P. O. Box 119, Columbus 16, Ohio. Direct communication is authorized.

2. Record and Report Forms

For record and report forms applicable to third, fourth, and fifth echelons of maintenance, refer to TM 5-505, Maintenance of Engineer Equipment.

Section II. DESCRIPTION AND DATA

3. Description

For a complete description of the centrifugal pump, refer to TM 5-4320-215-12.

4. Tabulated Data

a. *Engine Repair and Replacement Standards.* For engine repair and replacement standards, refer to TM 5-2805-209-35.

b. *Time Standards.* Table I lists the number of man-hours required under normal conditions for various operations in the maintenance and repair of the Carver Pump Company, Model K400S Centrifugal Pump. The man-hours listed are not intended to be rigid standards. Under adverse conditions, the operations will take considerably longer; whereas under ideal -conditions with highly skilled mechanics, most of the operations can be accomplished in considerably less time.

Table I. Time Standards

Hours

(1) *Lubrication and service:*

01 ENGINE	
0100 Engine Assembly	
Engine, gasoline	
(Drain, flush, and refill crankcase, replace filter element)	0.7
03 FUEL SYSTEM	
0306 Tanks, Lines, Fittings	
Tanks, gasoline	
(Remove; clean and replace screen; drain and flush tank;	
replenish with fuel).....	0.7
06 ELECTRICAL SYSTEM (ENGINE AND VEHICULAR)	
0601 Generator	
Generator, engine accessory, electrical	
(Fill oil cup).....	0.1

Table I. Time Standards-Continued

	<i>Hours</i>
Battery, storage (Fill with water to proper level, clean terminals)	0.2
13 WHEELS AND TRACKS	
1311 Wheel Assembly	
Cone and rollers, tapered roller bearing (Clean and repack with lubricant)	0.5
1313 Tires, Tubes	
Inner tube, pneumatic (Check pressure and inflate)	0.1
55 PUMPS (EXCLUDE ENGINE PUMPS)	
5500 Pump Assembly	
Pump assembly (priming and draining)	0.1
5505 Lubricators	
Cup, grease (Fill grease cup)	0.1
 (2) Remove and replace.	
01 ENGINE	
0100 Engine Assembly	
Engine, gasoline (Includes removal and installation of pump and lifting bail)	2.5
0111.1 Hand-Cranking Devices	
Clamp, hand crank	0.1
03 FUEL SYSTEM	
0306 Tanks, Lines, Fittings	
Tank, gasoline	0.5
06 ELECTRICAL SYSTEM (ENGINE AND VEHICULAR)	
0601 Generator	
Generator, engine accessory, electrical	0.4
Belt, V (includes adjustment)	0.4
0602 Generator Regulator	
Regulator, engine generator (includes adjustment)	1.5
0607 Instrument or Engine Control Panel	
Ammeter	0.3
0612 Batteries	
Battery, storage	0.2
0615 Radio Suppression	
Capacitor	0.3
11 REAR AXLE	
1100 Rear Axle Assembly	
Axle assembly (Includes removal and installation of wheels and hubs as an assembly)	1.5
13 WHEELS AND TRACKS	
1311 Wheel Assembly	
Cone and rollers, tapered roller bearing	0.5
1313 Tires, Tubes	
Inner tube, pneumatic	1.0

Table I. Time Standards-Continued

Hours

15 FRAME	
1501 Frame Assembly	
Base, cart	5.0
1503 Pintles and Towing Attachments	
Tongue	0.4
1507 Landing Gear; Leveling Jacks	
Foot, cart	0.1
22 MISCELLANEOUS BODY, CHASSIS OR HULL, AND ACCESSORY ITEMS	
2202.1 Mirrors, Reflectors, Personnel Heaters, Defrosters, Wipers, Air Horns	
Reflectors, indicator, clearance	0.1
2210 Data Plates and Instruction Holders	
Plate, identification	0.1
26 ACCESSORIES, PUBLICATIONS, TEST EQUIPMENT AND TOOLS	
2602.1 Accessories	
Chock assembly	0.1
47 GAGES (NON-ELECTRICAL); WEIGHING AND MEASURING DEVICES	
4705 Fuel Gages (Quantity)	
Gage, fuel	0.1
55 PUMPS (EXCLUDE ENGINE PUMPS)	
5500 Pump Assembly	
Pump assembly (Replacement consists of complete disassembly and reassembly of the pump)	1.0
5501 Volute, Housing	
Chamber, pump (Replacement consists of complete disassembly and reassembly of the pump)	1.0
5502 Impeller; Rotor, Diaphragm	
Impeller (Includes removal and installation of suction head and flange as an assembly)	0.3
5504 Discharge Assembly	
Elbow, street	0.1
5504.2 Suction Valve, Suction Heads	
Suction, Head (includes adjustment)	0.8
5505 Lubricators	
Cup, grease	0.1
5508.2 Pump Drive Assembly	
Seal, bellows, shaft (includes removal and installation of the pump chamber)	1.0
76 FIRE FIGHTING EQUIPMENT	
7603 Fire Extinguishers	
Extinguishers, fire	0.1

c. *Nut and Bolt Torque Data.* For nut and bolt torque data, refer to TM 5-2805-209-35.

Chapter 2

GENERAL MAINTENANCE INSTRUCTIONS AND TROUBLESHOOTING

Note: No special tools or equipment are needed to perform field and depot maintenance on this centrifugal pump.

5. General

This chapter provides information useful in diagnosing and correcting unsatisfactory operation of the centrifugal pump or any of its components. Each trouble symptom stated is followed by a list of probable causes of trouble. The possible remedy recommended is described opposite the probable cause.

6. Engine and Pump

For engine and pump troubleshooting, refer to TM 5-

2805-209-35 and TM 5-X320-215-12.

7. Battery-Charging Generator Fails to Charge

<i>Probable cause</i>	<i>Possible remedy</i>
Armature defective	Replace the armature (par. 9).
Field coils defective	Replace the field coils (par. 9).
Brush holders and/or brush tension springs defective	Replace brush holders and/or brush tension springs (par. 9).

AGO 4615A

Chapter 3

BATTERY-CHARGING GENERATOR REPAIR INSTRUCTIONS

8. General

The battery-charging generator is a beltdriven, air-cooled, externally controlled unit of the two-brush type. One brush is grounded so that the generator stator frame serves as conductor in the ground return portion of the electrical circuit. The other brush, mounted in an insulated brush holder, is connected to the armature terminal of the generator. One field lead connects to the insulated brush holder. The other field lead connects to the field terminal of the generator.

9. Battery-Charging Generator

- a. Remove and install the battery-charging generator (TM 5-4320-215-12).
- b. Disassemble and reassemble the battery-charging generator as shown by figure 1.
- c. Clean, inspect, and repair.
- d. Test the brush holder, armature, and field coils as described in TM 5-764.

AGO 4615A

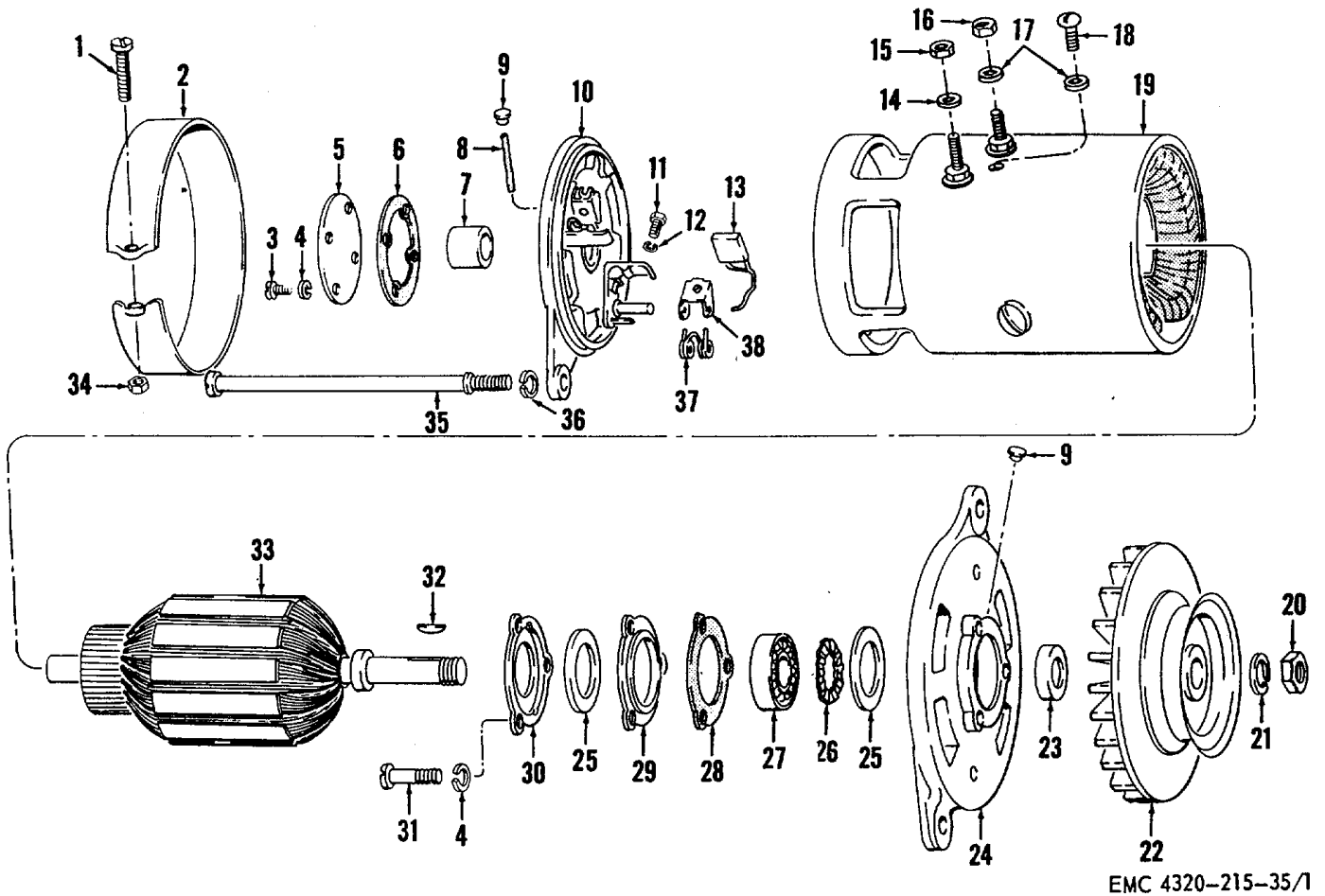

EMC 4320-215-35/1

- | | | | |
|----|---|----|---|
| 1 | Screw, machine, No. 10-32 x 1 1/2 in. | 20 | Nut (spec) |
| 2 | Cover band | 21 | Washer, lock, 5/8 in. |
| 3 | Screw, machine, brass, No. 10-32 x 5/16 in. (3 rqr) | 22 | Pulley |
| 4 | Washer, lock, No. 10 (3 rqr) | 23 | Spacer |
| 5 | Cover | 24 | Head |
| 6 | Gasket | 25 | Packing (2 rqr) |
| 7 | Bearing | 26 | Retainer |
| 8 | Wick | 27 | Bearing |
| 9 | Oiler (2 rqr) | 28 | Gasket |
| 10 | Head | 29 | Retainer |
| 11 | Screw, machine, No. 8-32 x 1/4 in. (2 rqr) | 30 | Retainer |
| 12 | Washer, lock, No. 8 (2 rqr) | 31 | Screw, machine, No. 10-32 x 1/2 in. (3 rqr) |
| 13 | Brush | 32 | Key, woodruff, No. 505 |
| 14 | Washer, lock, 1/4 in. | 33 | Armature |
| 15 | Nut, plain, hex, 1/4-28 | 34 | Nut, plain, hex, No. 10-32 |
| 16 | Nut, plain, hex, No. 10-32 | 35 | Through-bolt |
| 17 | Washer, lock, IT. No. 10 (2 rqr) | 36 | Washer, lock, 5/16 in. |
| 18 | Screw, machine, No. 10-32 x 5/16 in. | 37 | Spring |
| 19 | Stator and field | 38 | Arm |

Figure 1. Battery-charging generator, disassembly and reassembly.

Chapter 4

FUEL TANK, AXLE, AND CART BASE REPAIR INSTRUCTIONS

10. General

This chapter includes repair instructions for the fuel tank as well as the cart base and axle. The cart base is a welded-steel structure specially designed and drilled for securing the engine and pump in alignment. The axle is of one piece construction and secured to the underside of the frame by means of U-shaped brackets welded to the axle.

11. Fuel Tank

- a. Remove and install the fuel tank (TM 5-4320-

215-12).

- b. Clean, inspect, and repair.

Warning: Do not attempt to repair an empty tank near an open flame. Be sure the tank is full of water before soldering or brazing.

12. Axle

- a. Remove and install the wheel, tire, and tube (TM 5-4230-215-12).

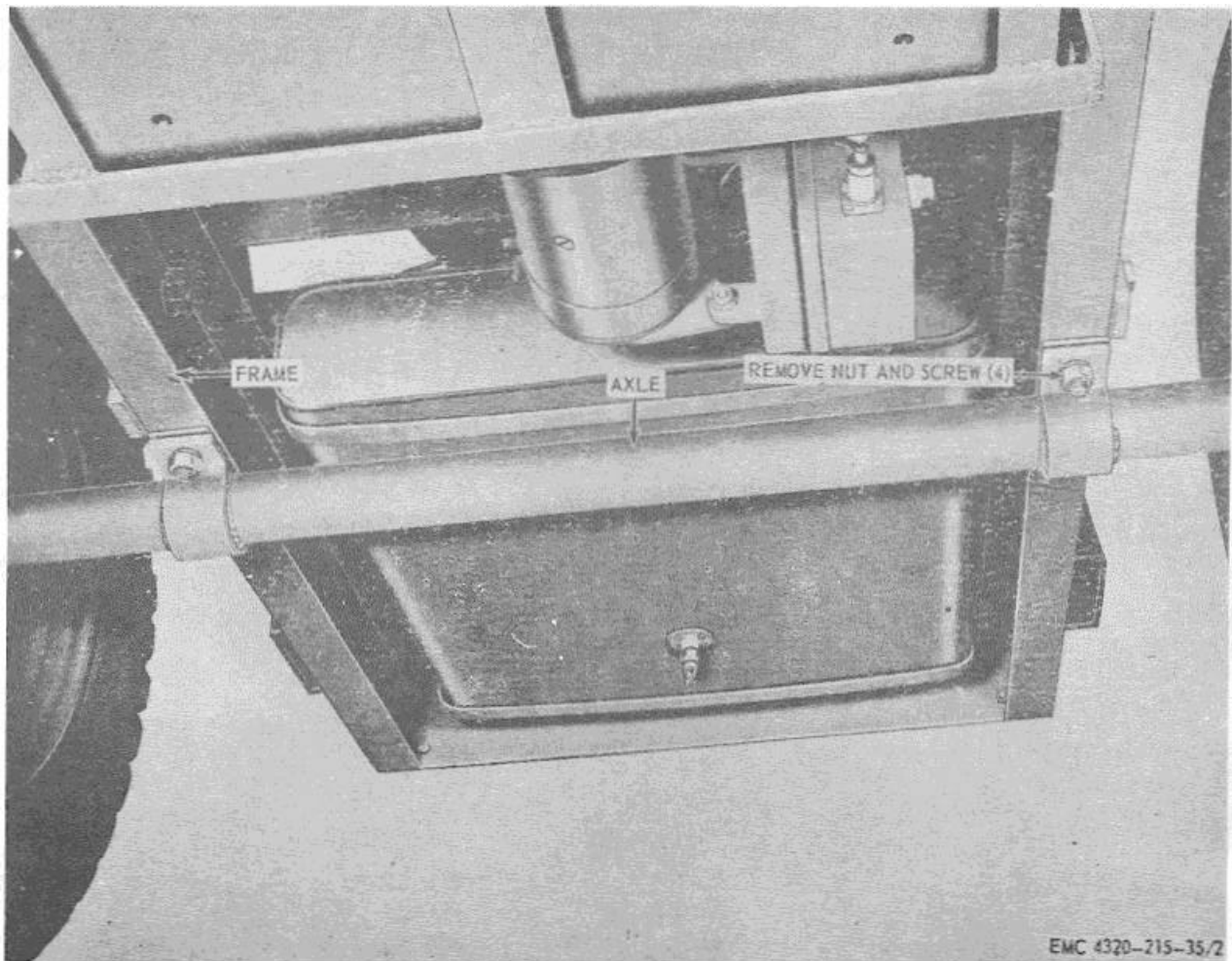

Figure 2. Axle, removal and installation.

- b. Remove and install the axle as shown by figure 2.
- c. Clean, inspect, and repair.

13. Cart Base

- a. Remove and install the battery box and cables (TM 5-4320-215-12).
- b. Remove and install the fuel tank and fuel line (TM 5-4320-215-12).
- c. Remove and install the generator and voltage

regulator (TM 5-4320-215-12).

- d. Remove and install the engine and centrifugal pump (TM 5-4320-215-12).
- e. Remove and install the lunette, tongue, lifting bail, cart foot, reflector, wheel chock, crank holddown bracket, and fire extinguisher bracket (8M 5-4320-215-12).
- f. Remove and install the axle (par. 12).
- g. Clean, inspect, and repair.

AGO 4615A

APPENDIX

REFERENCES

1. Dictionaries of Terms and Abbreviations

AR 320-5 Dictionary of United States Army Terms.
AR 320-50 Authorized Abbreviations and Brevity Codes.

2. Field and Depot Maintenance

TM 5-764 Electric Motor and Generator Repair.
TM 5-2805-209-35 Field and Depot Maintenance Manual Engine, Gasoline (Wisconsin Model MVF4D).

3. Fire Protection

TM 5-687 Repairs and Utilities: Fire Protection Equipment and Appliances; Inspections, Operations, and Preventive Maintenance.
TM 9-1799 Ordnance Maintenance: Fire Extinguishers.

4. Lubrication

LO 5-4320-215-12 Pump Centrifugal: Fresh Water; Gasoline Driven; 2 Wheel Mounted; 4 In., 500 Gpm, 30 Ft Head (Carver Model K400S) W/Wisconsin Engine Model MVF4D.

5. Operator and Organizational Maintenance

TM 5-2805-209-12 Operator and Organizational Maintenance Manual Engine, Gasoline (Wisconsin Model MVF4D).
TM 5-4320-215-12 Operator and Organizational Maintenance Manual Pump, Centrifugal: Fresh Water; Gasoline Driven; 2 Wheel Mounted; 4 In., 500 Gpm, 30 Ft Hd (Carver Model K400S) (Less Engine).

6. Painting

TM 9-2851 Painting Instructions for Field Use.

7. Preventive Maintenance

AR 700-38 Unsatisfactory Equipment Report.
AR 750-5 Maintenance Responsibilities and Shop Operation.
TM 5-505 Maintenance of Engineer Equipment.

8. Publication Indexes

DA Pam 108-1 Index of Army Motion Pictures, Film Strips, Slides, and Phono-Recordings.
DA Pam 310-1 Index of Administrative Publications.
DA Pam 310-2 Index of Blank Forms.
DA Pam 310-3 Index of Training Publications.
DA Pam 310-4 Index of Technical Manuals, Technical Bulletins, Supply Bulletins, Lubrication Orders, and Modification Work Orders.
DA Pam 310-5 Index of Graphic Training Aids and Devices.
DA Pam 310-25 Index of Supply Manuals-Corps of Engineers.

AGO 4615A

9. Radio Interference Suppression

TM 11-483 Radio Interference Suppression.

10. Supply Publications

TM 5-2805-209-35P Field and Depot Maintenance Repair Parts and Special Tool Lists Engine, Gasoline (Wisconsin Model MVF4D).

TM 5-2805-209-20P Organizational Maintenance Repair Parts and Special Tool Lists Engine, Gasoline (Wisconsin Model MVF4D).

TM 5-4320-21L5-20P Organizational Maintenance Repair
Repair Parts and Special Tool Lists
Pump, Centrifugal: Fresh Water; Gasoline Driven; 2 Wheel Mounted;
4 In., 500 Gpm, 30 Ft Head (Carver Model K400S) FSN 4320-810-7311
(Less Engine).

TM 5-4320-215-35P Field and Depot Maintenance Repair Parts and Special Tool Lists
Pump Centrifugal: Fresh Water; Gasoline Driven; 2 Wheel Mounted;
4 In., 500 Gpm, 30 Ft Head (Carver Model K400S) FSN 4320-810-7311
(Less Engine).

11. Training Aids

FM 5-25 Explosives and Demolition.

FM 21-5 Military Training.

FM 21-6 Techniques of Military Instruction.

FH 21-30 Military Symbols.

BY ORDER OF THE SECRETARY OF THE ARMY:

Official:

R. V. LEE,
*Major General, United States Army,
The Adjutant General*

G. H. DECKER,
*General, United States Army,
Chief of Staff.*

Distribution:

Active Army:

To be distributed in accordance with DA Form 12-7 requirements for TM 5-series (unclas) plus the following formula:

DCSLOG (1)	MDW (1)	5-48 (2)
USASA (2)	Seventh US Army (2)	5-237 (5)
CNGB (1)	EUSA (2)	5-262 (5)
Tech Stf, DA (1) except	Corps (2)	5-267 (1)
CofEngrs (3)	Div (2)	5-278 (5)
USAABELCTBD (2)	USAES (100)	5-279 (2)
US ARADCOM (2)	JBUSMC (1)	5-500 (EA, EB) (2)
US ARADCOM Rgn (2)	Units org under fol TOE:	

NG: State AG (3).

USAR: Same as active army except allowance is one copy each unit.

For explanation of abbreviations used, see AR 320-50.

☆ U.S. GOVERNMENT PRINTING OFFICE : 1992 - 311-831 (43770)

AGO 4615A

RECOMMENDED CHANGES TO EQUIPMENT TECHNICAL PUBLICATIONS



SOMETHING WRONG WITH PUBLICATION

FROM: (PRINT YOUR UNIT'S COMPLETE ADDRESS)

DATE SENT

PUBLICATION NUMBER

PUBLICATION DATE

PUBLICATION TITLE

BE EXACT PIN-POINT WHERE IT IS

PAGE NO.

PARA-GRAPH

FIGURE NO.

TABLE NO.

IN THIS SPACE, TELL WHAT IS WRONG AND WHAT SHOULD BE DONE ABOUT IT.

PRINTED NAME, GRADE OR TITLE AND TELEPHONE NUMBER

SIGN HERE

TM 5-4320-215-35 PUMP, CENTRIFUGAL: FRESH WATER: GASOLINE DRIVEN-1961

PIN : 026876-000